

AXIS TA4401 Braille Label

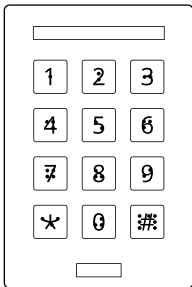

Installation Guide

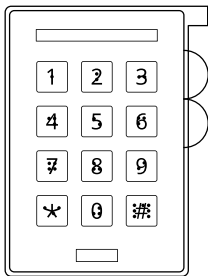

10x

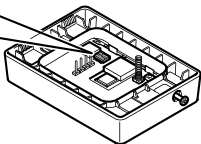
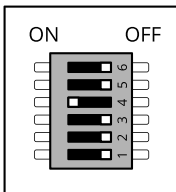

[help.axis.com/
axis-a4120-e#dip-switches](http://help.axis.com/axis-a4120-e#dip-switches)

AXIS A4120-E
User manual

1.1

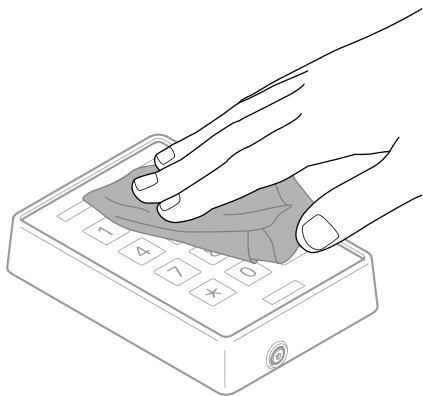

1.2

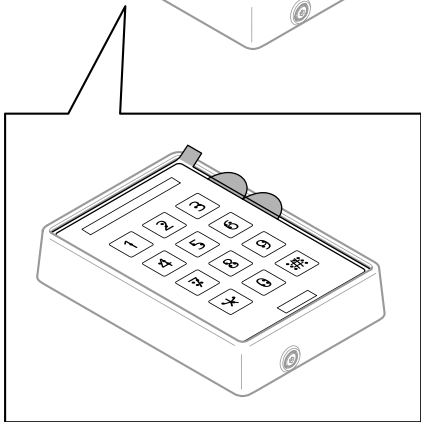
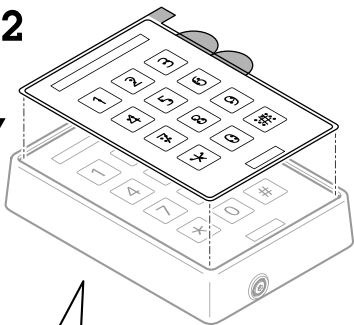

1.3

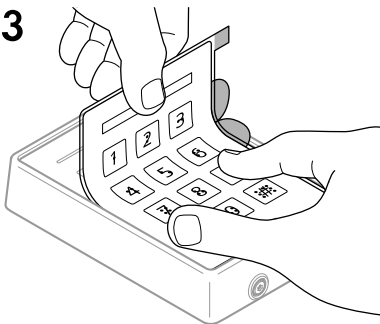

1.4

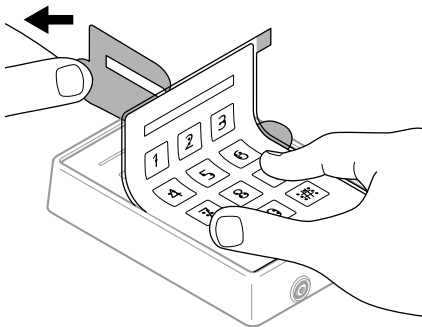

1.5

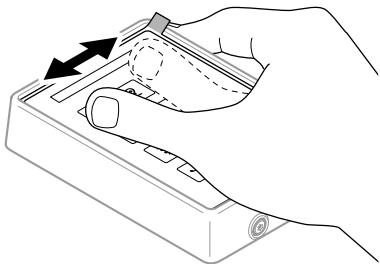

1.6

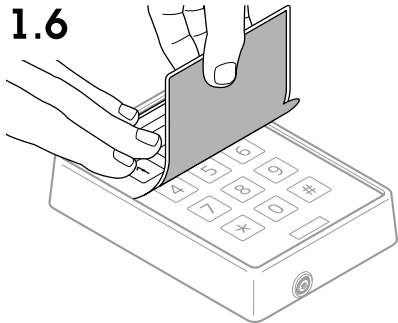

1.7

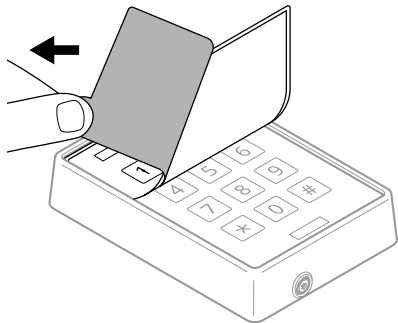

1.8

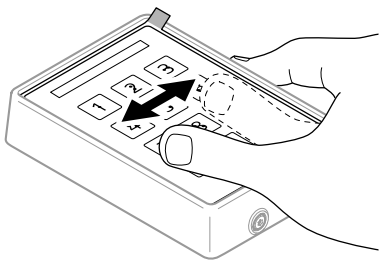

1.9

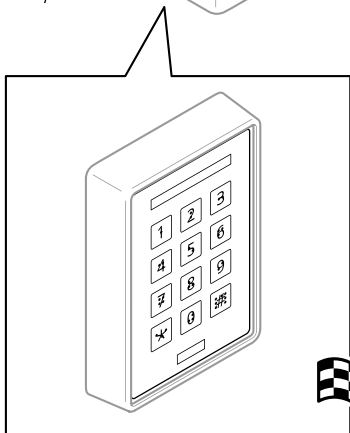
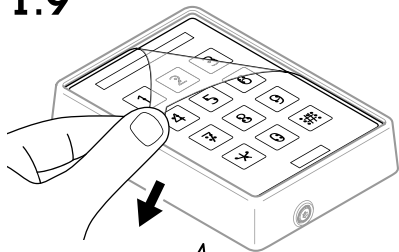

Installation Guide

AXIS TA4401 Braille Label

© 2022 Axis Communications AB

Ver. M2.2

Date: December 2022

Part No. 2450099