

KSM26SES8/16HC

16GB 1Rx8 2G x 72-Bit PC4-2666

CL19 260-Pin ECC SODIMM

DESCRIPTION

Kingston's KSM26SES8/16HC is a 2G x 72-bit (16GB) DDR4-2666 CL19 SDRAM (Synchronous DRAM) w/ parity, 1Rx8, ECC, memory module, based on nine 2G x 8-bit FBGA components. The SPD is programmed to JEDEC standard latency DDR4-2666 timing of 19-19-19 at 1.2V. Each 260-pin SODIMM uses gold contact fingers. The electrical and mechanical specifications are as follows:

FEATURES

- Power Supply: VDD = 1.2V
- VDDQ = 1.2V
- VPP = 2.5V
- VDDSPD = 2.20V to 3.60V
- Functionality and operations comply with the DDR4 SDRAM datasheet
- 16 internal banks
- Bank Grouping is applied, and CAS to CAS latency (tCCD_L, tCCD_S) for the banks in the same or different bank group accesses are available
- Data transfer rates: PC4-2666, PC4-2400, PC4-2133, PC4-1866, PC4-1600
- Bi-Directional Differential Data Strobe
- 8 bit pre-fetch
- Burst Length (BL) switch on-the-fly BL8 or BC4(Burst Chop)
- Supports ECC error correction and detection
- On-Die Termination (ODT)
- Temperature sensor with integrated SPD
- This product is in compliance with the RoHS directive.
- Per DRAM Addressability is supported
- Internal Vref DQ level generation is available
- Write CRC is supported at all speed grades
- CA parity (Command/Address Parity) mode is supported
- RoHS Compliant and Halogen-Free

SPECIFICATIONS

CL(IDD)	19 cycles
Row Cycle Time (tRCmin)	45.75ns(min.)
Refresh to Active/Refresh Command Time (tRFCmin)	350ns(min.)
Row Active Time (tRASmin)	32ns(min.)
Maximum Operating Power	*
UL Rating	94 V - 0
Operating Temperature	0° C to +85° C
Storage Temperature	-55° C to +100° C

*See IDD Specifications (page 2)

Module Assembly

DRAM: HYNIX (C-DIE)

Continued >>

IDD Specifications

IDD		unit
Symbol	2666	
IDD0	343	mA
IDD0A	343	mA
IDD1	405	mA
IDD1A	433	mA
IDD2N	253	mA
IDD2NA	253	mA
IDD2NT	283	mA
IDD2NL	175	mA
IDD2NG	252	mA
IDD2ND	229	mA
IDD2NP	257	mA
IDD2P	173	mA
IDD2Q	236	mA
IDD3N	477	mA
IDD3NA	475	mA
IDD3P	406	mA
IDD4R	1031	mA
IDD4RA	1041	mA
IDD4RB	1036	mA
IDD4W	989	mA
IDD4WA	1019	mA
IDD4WB	928	mA
IDD4WC	979	mA
IDD4WP	1089	mA
IDD5B	4746	mA
IDD5F2	3224	mA
IDD5F4	2521	mA
IDD6N	342	mA
IDD6E	544	mA
IDD6R	147	mA
IDD6A	579	mA
IDD7	1263	mA
IDD8	91	mA

IPP		unit
Symbol	2666	
IPP0	22	mA
IPP1	25	mA
IPP2N	8	mA
IPP2P	8	mA
IPP3N	10	mA
IPP3P	10	mA
IPP4R	45	mA
IPP4W	45	mA
IPP5B	484	mA
IPP5F2	316	mA
IPP5F4	262	mA
IPP6N	33	mA
IPP6E	58	mA
IPP6R	14	mA
IPP6A	51	mA
IPP7	132	mA
IPP8	8	mA

MODULE DIMENSIONS

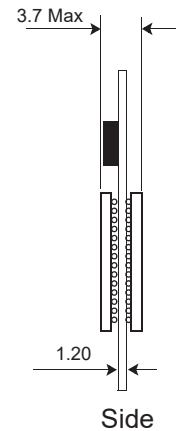
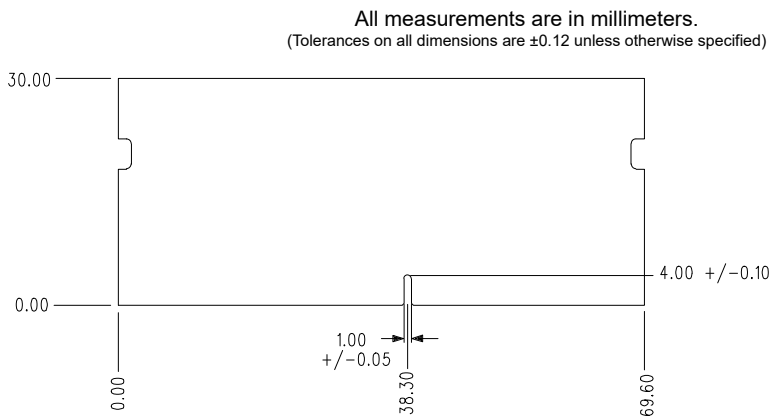
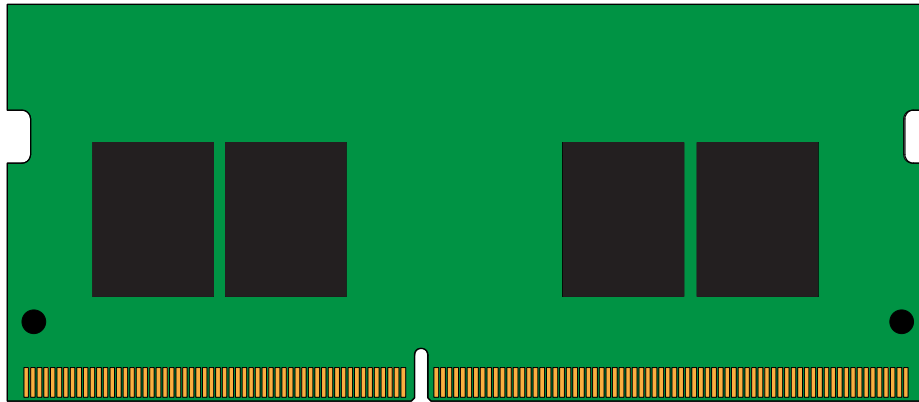
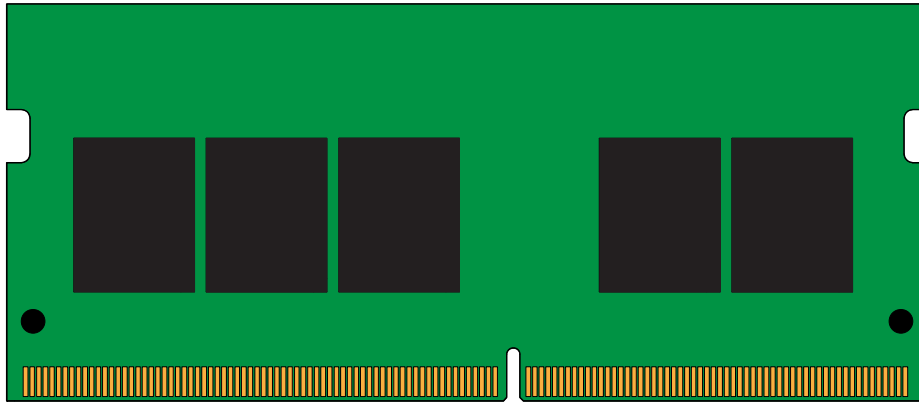

The product images shown are for illustration purposes only and may not be an exact representation of the product. Kingston reserves the right to change any information at anytime without notice.