

LIGHTNING CONNECTOR DOCK CONVERSION INSTRUCTIONS

INCLUDED WITH YOUR HOLDER:

- #4-40 X 3/8" MACHINE SCREW (QTY. 1)
- #4-40 NYLOCK NUT (QTY. 1)



1. INSERT IPAD INTO HOLDER (HOLDER DESIGN MAY VARY)
2. INSERT LIGHTNING CONNECTOR CABLE. VERIFY THAT YOUR IPAD RECOGNIZES THE CABLE AND IS PROPERLY CONNECTED.

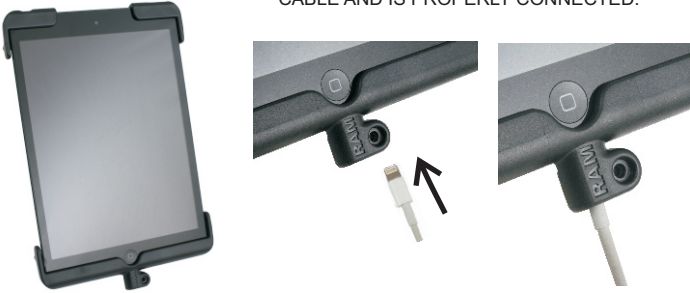

3. ASSEMBLE SCREW & NUT, CLAMPING LIGHTNING CONNECTOR IN PLACE. CHECK ASSEMBLY PERIODICALLY, RE-TIGHTEN SCREW AND NUT AS NEEDED.

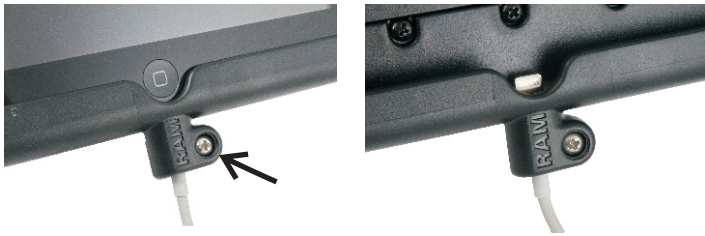

RMR-INS-TABD14

National Products, Inc. 8410 Dallas Ave S. Seattle, WA 98108
206-763-8361 www.rammount.com

LIGHTNING CONNECTOR DOCK CONVERSION INSTRUCTIONS

INCLUDED WITH YOUR HOLDER:

- #4-40 X 3/8" MACHINE SCREW (QTY. 1)
- #4-40 NYLOCK NUT (QTY. 1)



1. INSERT IPAD INTO HOLDER (HOLDER DESIGN MAY VARY)
2. INSERT LIGHTNING CONNECTOR CABLE. VERIFY THAT YOUR IPAD RECOGNIZES THE CABLE AND IS PROPERLY CONNECTED.

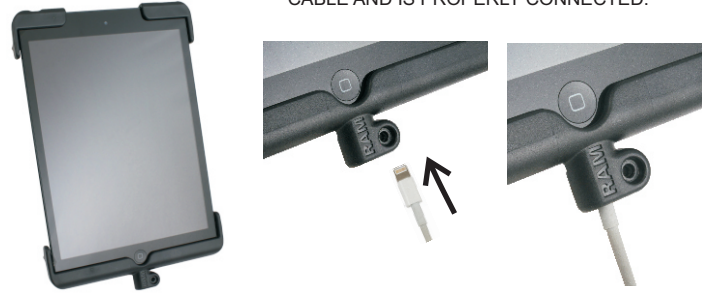

3. ASSEMBLE SCREW & NUT, CLAMPING LIGHTNING CONNECTOR IN PLACE. CHECK ASSEMBLY PERIODICALLY, RE-TIGHTEN SCREW AND NUT AS NEEDED.

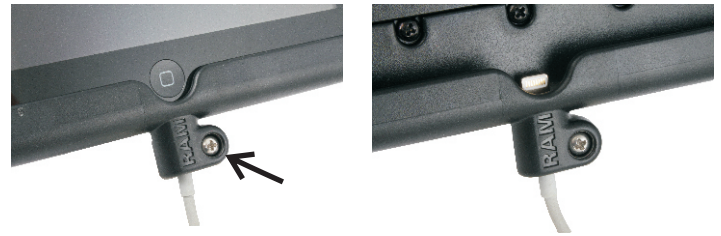

RMR-INS-TABD14

National Products, Inc. 8410 Dallas Ave S. Seattle, WA 98108
206-763-8361 www.rammount.com

LIGHTNING CONNECTOR DOCK CONVERSION INSTRUCTIONS

INCLUDED WITH YOUR HOLDER:

- #4-40 X 3/8" MACHINE SCREW (QTY. 1)
- #4-40 NYLOCK NUT (QTY. 1)



1. INSERT IPAD INTO HOLDER (HOLDER DESIGN MAY VARY)
2. INSERT LIGHTNING CONNECTOR CABLE. VERIFY THAT YOUR IPAD RECOGNIZES THE CABLE AND IS PROPERLY CONNECTED.



3. ASSEMBLE SCREW & NUT, CLAMPING LIGHTNING CONNECTOR IN PLACE. CHECK ASSEMBLY PERIODICALLY, RE-TIGHTEN SCREW AND NUT AS NEEDED.

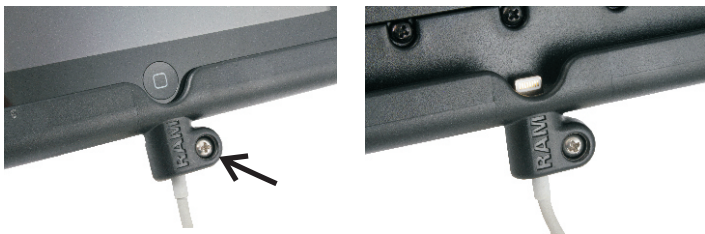

RMR-INS-TABD14

National Products, Inc. 8410 Dallas Ave S. Seattle, WA 98108
206-763-8361 www.rammount.com

LIGHTNING CONNECTOR DOCK CONVERSION INSTRUCTIONS

INCLUDED WITH YOUR HOLDER:

- #4-40 X 3/8" MACHINE SCREW (QTY. 1)
- #4-40 NYLOCK NUT (QTY. 1)



1. INSERT IPAD INTO HOLDER (HOLDER DESIGN MAY VARY)
2. INSERT LIGHTNING CONNECTOR CABLE. VERIFY THAT YOUR IPAD RECOGNIZES THE CABLE AND IS PROPERLY CONNECTED.

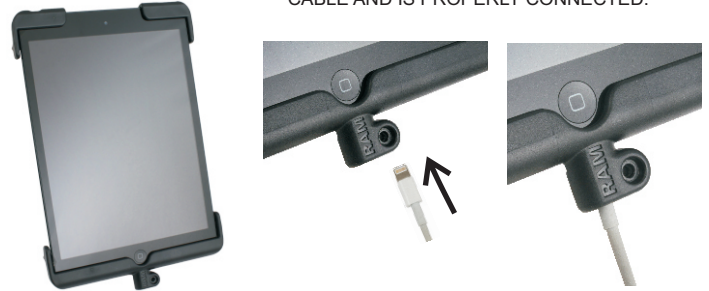

3. ASSEMBLE SCREW & NUT, CLAMPING LIGHTNING CONNECTOR IN PLACE. CHECK ASSEMBLY PERIODICALLY, RE-TIGHTEN SCREW AND NUT AS NEEDED.

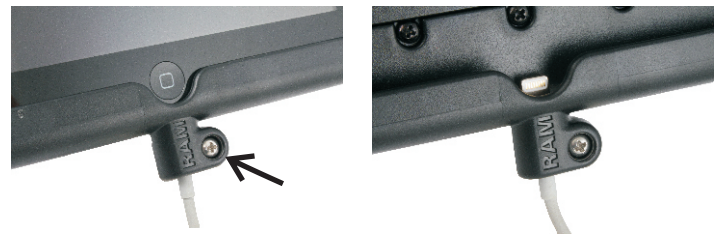

RMR-INS-TABD14

National Products, Inc. 8410 Dallas Ave S. Seattle, WA 98108
206-763-8361 www.rammount.com