

# EVOLVE<sup>2</sup> 85



User manual

© 2020 GN Audio A/S. All rights reserved. Jabra® is a trademark of GN Audio A/S. The Bluetooth® word mark and logos are registered trademarks owned by the Bluetooth SIG, Inc. and any use of such marks by GN Audio A/S is under license.

---

Made in China

MODEL: HSC120W



 **Bluetooth®**

---

**Declaration of Conformity** can be found on  
[www.jabra.com/doc](http://www.jabra.com/doc)

1. Welcome.....	5
2. Jabra Evolve2 85 overview.....	6
2.1 Included accessories	
2.2 Optional accessories	
3. How to wear .....	8
3.1 Adjusting the headset	
3.2 Positioning the microphone boom arm	
3.3 Fold flat for storage	
4. How to charge .....	11
4.1 Charge using the charging stand (optional accessory)	
4.2 Charge using USB charging cable	
4.3 Sleep mode	
5. What the LEDs mean .....	15
6. How to connect.....	16
6.1 Connect to computer	
6.2 Pair with a smartphone	
6.3 Connect to 3.5mm jack port	
7. How to use .....	19
7.1 Power on/off	
7.2 Calls & music	
7.3 On-ear detection	

7.4	Switching microphones	
7.5	Voice Assistant	
7.6	Busylights	
7.7	Active Noise Cancellation (ANC)	
7.8	HearThrough™	
7.9	Mute/unmute using the microphone boom arm	
7.10	Answer call using the microphone boom arm	
7.11	Multiuse	
7.12	Multiple call handling	
7.13	Voice guidance	
7.14	How to reset	
8.	Software and firmware.....	36
8.1	Jabra Sound+	
8.2	Jabra Direct	
8.3	Update firmware	
9.	Support .....	38
9.1	FAQ	
9.2	How to care for your headset	

# 1. Welcome

Thank you for using the Jabra Evolve2 85. We hope you will enjoy it!

## **Jabra Evolve2 85 features**

- Designed for all day comfort
- Active Noise Cancellation (ANC)
- 4-microphone call technology
- Up to 37 hours wireless battery life
- 40mm speakers and AAC codec for immersive music
- 360° busylight visible from all angles
- Up to 30m/100ft wireless range, with significantly enhanced coverage and fewer dropouts
- Works with all leading UC platforms, Microsoft Teams-certified variants available

## 2. Jabra Evolve2 85 overview

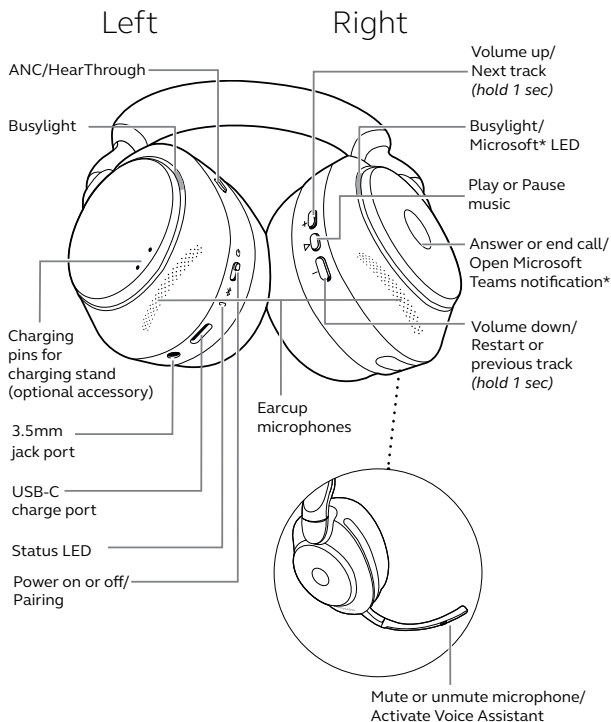

\*requires Microsoft Teams headset variant

## 2.1 Included accessories

---



Jabra Link 380 USB-A  
Bluetooth adapter



Jabra Link 380 USB-C  
Bluetooth adapter



Carry case



USB-A to USB-C  
cable



3.5mm jack cable

## 2.2 Optional accessories

---



USB-A or USB-C  
Charging Stand



Replacement ear cushions

## 3. How to wear

### 3.1 Adjusting the headset

---

Adjust the headband so that the headset fits your head comfortably.

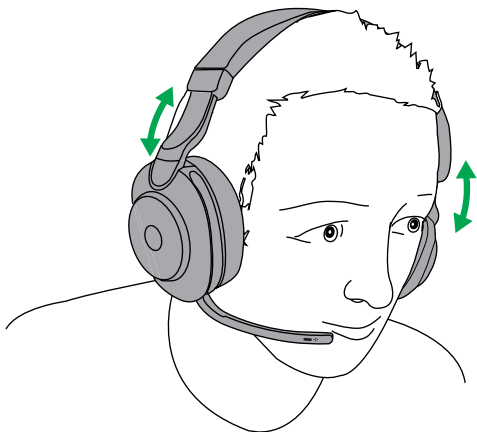



## 3.2 Positioning the microphone boom arm

---

Rotate the microphone boom arm down or up in one smooth motion.

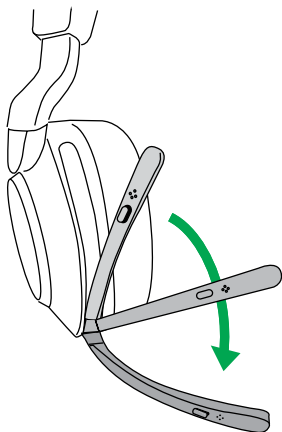

When using the microphone, the tip of the boom arm should be positioned close to your mouth.

### 3.3 Fold flat for storage

---

The earcups can be folded flat for easy storage inside the carry case.

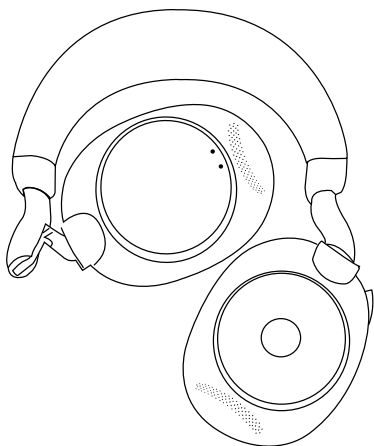

## 4. How to charge

The headset can be charged using the optional charging stand, or via a USB charging cable plugged directly into the headset.

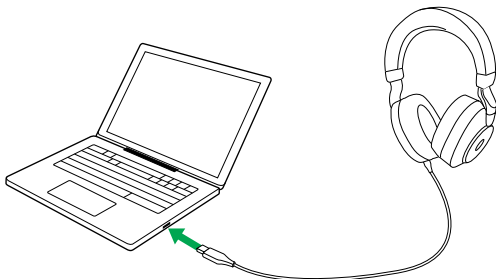

It takes approx. 2 hours and 20 minutes to fully charge the battery. The headset battery life is up to 37 hours. If the headset is out of battery, they can be charged for 15 minutes to get 8 hours of battery life.

## 4.1 Charge using the charging stand (optional accessory)

---

Connect the charging stand to a powered USB port on your computer using the supplied USB charging cable, and then dock the headset on the charging stand.

Powered USB port

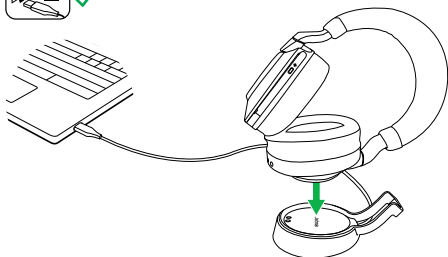

The status LED on the headset will flash white briefly to indicate the headset has been correctly docked with the charging stand.

The battery LED will then briefly flash green, yellow or red to indicate the current battery charging status. When the LED turns solid green, the headset is fully charged.

## 4.2 Charge using USB charging cable

---

Plug the USB charging cable into the USB-C charging port on the left earcup and any available USB port on your computer. It is recommended to charge the headset using the supplied Jabra charging cable, however it is possible to use a compatible charger.

Left earcup

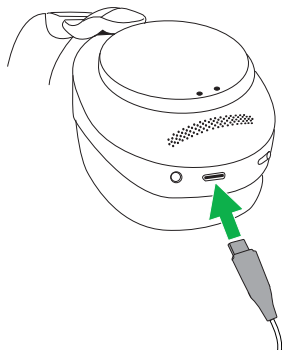

## 4.3 Sleep mode

---

When the headset is powered on, but not being worn, they will automatically enter sleep mode after 8 hours to conserve battery. To exit sleep mode, simply press any button.

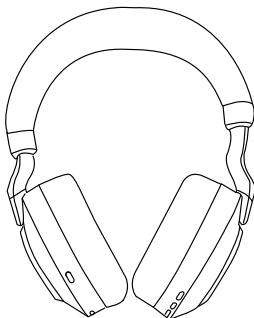

The length of time before the headset enters sleep mode can be adjusted using the Jabra Sound+ app on your smartphone or Jabra Direct on your computer.

After 24 hours of sleep mode, the headset will power down completely. To power the headset on, slide the On/Off switch to Off and then On.

# 5. What the LEDs mean

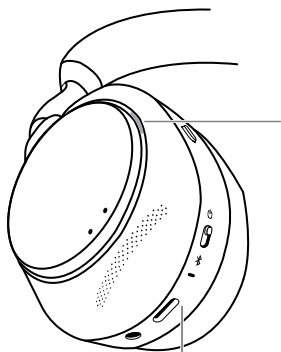

## STATUS LED (Left earcup)

- Power on/Battery full
- Battery medium
- Battery low
- Battery critically low
- Pairing mode
- Resetting/Firmware updating
- Headset docked in optional charging stand

## BUSYLIGHT/MICROSOFT\* LED

- Busylight
- Incoming call
- (slow flash) Headset is trying to connect to Microsoft Teams. Will time out after 10 seconds\*
- (fast flash) Microsoft Teams notification\*

## LED

- Microphone muted
- Plugged into computer and signed into Microsoft Teams\*
- (slow flash) Headset is trying to connect to Microsoft Teams. Will time out after 10 seconds\*
- (fast flash) Microsoft Teams notification\*
- Bluetooth connection
- Streaming music/media
- Incoming call/Active call

\*requires Microsoft Teams headset variant

# 6. How to connect

## 6.1 Connect to computer

---

Plug the supplied Jabra Link 380 into a USB port on your computer. The Jabra Evolve2 85 and the Jabra Link 380 are pre-paired and ready for use out of the box. The Bluetooth range is up to 30 meters or 100 feet.

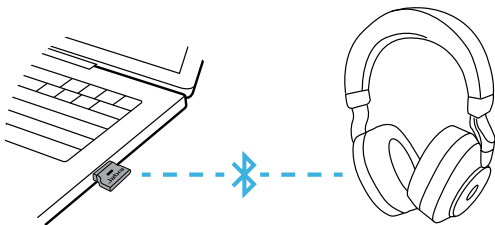

To hear audio in the headset you may need to select the Jabra Link 380 as the playback device in your operating system's audio settings.

To manually pair the Jabra Evolve2 85 with the Jabra Link 380, download and use Jabra Direct.



## 6.2 Pair with a smartphone

---

1. Slide the **On/Off** switch to the **Bluetooth** position and hold it there until the LED flashes blue and you hear an announcement in the headset.

Left earcup

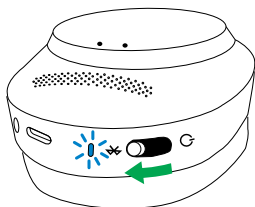

2. Go to the Bluetooth menu on your smartphone and select the Jabra Evolve2 85 from the list of available devices.

## 6.3 Connect to 3.5mm jack port

---

Plug the supplied audio jack cable into the 3.5mm audio jack port on the headset.

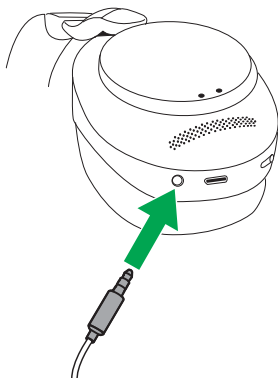

When connected to a device using the audio jack cable, the headset microphone and Bluetooth are disabled. If the headset is plugged into a smartphone, the smartphone's microphone will be used for calls.

The volume and ANC/HearThrough can be controlled using the buttons on the headset.

# 7. How to use

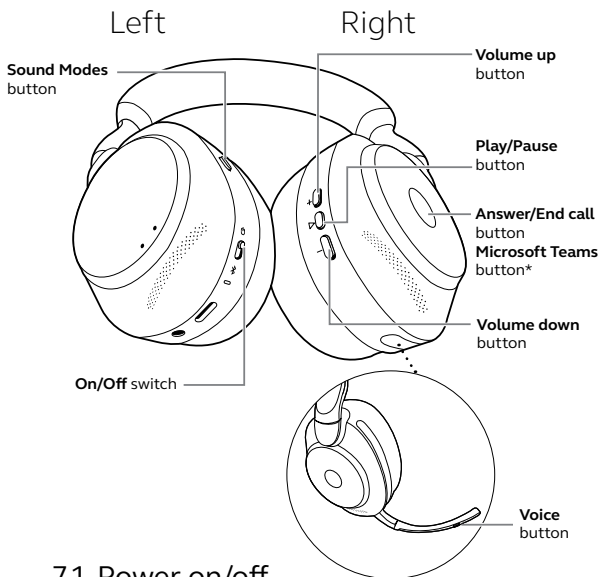

## 7.1 Power on/off

Slide the **On/Off** switch to the **On** or **Off** position to power the headset on or off.

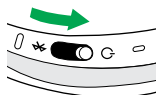

\*requires Microsoft Teams variant

## 7.2 Calls & music

---

### Right earcup Calls & music

---

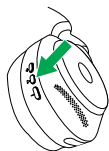

Play/pause music

Press the **Play/Pause** button

---

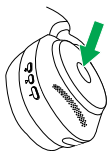

Answer call

Press the **Answer/End call** button

Alternatively, move the microphone boom arm down to answer an incoming call. See section 7.10

---

End call

Press the **Answer/End call** button

---

Reject call

Double-press the **Answer/End call** button

---

---

Bring Microsoft Teams to foreground on computer

Press the **Microsoft Teams** button\* (when signed into Microsoft Teams)

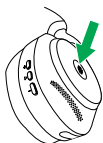

Join active Microsoft Teams meeting

Press the **Microsoft Teams** button\* (when signed into Microsoft Teams)

View Microsoft Teams missed calls and voicemails

Press the **Microsoft Teams** button\* (when signed into Microsoft Teams)

---

Adjust volume

Press the **Volume up** or **Volume down** button, when listening to music or on a call

Next track

Press and hold (1 sec) the **Volume up** button

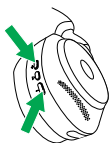

Restart track

Press and hold (1 sec) the **Volume down** button to restart the current track

Press and hold twice to play the previous track

---

Hear battery and connection status

Press the **Volume up** or **Volume down** button, when not listening to music or on a call

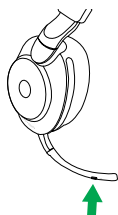

Activate Voice Assistant (i.e. Siri, Google Assistant)

Press the **Voice** button, when not on a call

Press the **Voice** button, when on a call

Mute/unmute microphone

Alternatively, move the microphone boom arm up to mute, or down to unmute. See section 7.9

#### Left earcup

#### Sound modes

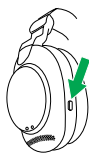

Cycle between Sound modes: ANC, Off, HearThrough

Press the **Sound modes** button

Press and hold (1 sec) the **Sound modes** button

Cycle between Moments in Jabra Sound+

Moments can be customized in the Jabra Sound+ app

## 7.3 On-ear detection

---

The headset has built-in sensors that can detect when the headset is being worn and will perform different actions depending on if the headset is being worn or not.

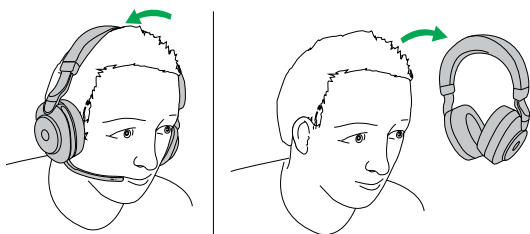

### *AUTO-PAUSE MUSIC*

When listening to music, taking off the headset will automatically pause the music. Wear the headset again to automatically resume the music.

### *MUTE CALL*

When you are on a call, taking off the headset will automatically mute the call. Wear the headset again to automatically unmute the call.

### *BUSYLIGHTS*

The Busylight LEDs will only light up red when the headset is being worn.

### *MICROSOFT TEAMS STATUS\**

The Microsoft Teams status LED will only indicate Microsoft notifications when the headset is not being worn.

Head detection and each individual action can be configured using the Jabra Sound+ app on your smartphone or Jabra Direct on your computer.

\*requires Microsoft Teams headset variant



## 7.4 Switching microphones

---

To use the earcup microphones instead of the boom arm microphone, raise the boom arm and then press the Voice button on the boom arm.

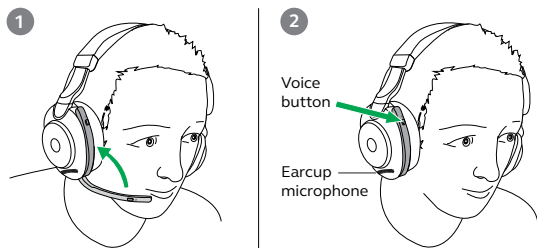

To use the boom arm microphone instead of the earcup microphones, lower the boom arm.

## 7.5 Voice Assistant

---

The Jabra Evolve2 85 enables you to speak to Siri, Google Assistant on your smartphone using the **Voice** button.

Right earcup

Voice Assistant



Activate Voice Assistant (i.e. Siri, Google Assistant)

Press the **Voice** button, when not on a call

## 7.6 Busylights

---

The Busylights on the headset automatically light up red when you are on a call to indicate to colleagues that you are busy. To manually switch the Busylights on/off, press the Volume up and Volume down buttons at the same time.

Please note that the Busylights will only light up when you are wearing the headset.

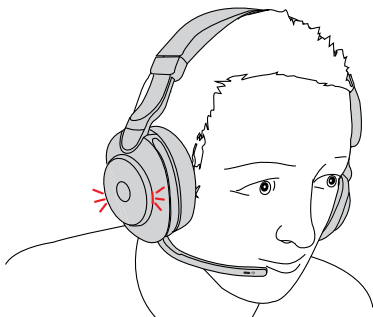

Busylight settings can be configured using the Jabra Sound+ app on your smartphone or Jabra Direct on your computer.

## 7.7 Active Noise Cancellation (ANC)

---

Active Noise Cancellation (ANC) counters noise. It detects and analyzes the pattern of incoming sound, and then generates an antinoise signal to cancel it out. As a result, you experience a drastically reduced level of surrounding noise.

ANC settings can be configured using the Jabra Sound+ app on your smartphone or Jabra Direct on your computer.

Left earcup

ANC

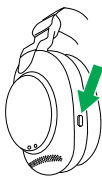

Turn on ANC

Press the **Sound modes** button to cycle through the available Sound modes until ANC is announced

## 7.8 HearThrough™

---

HearThrough utilizes the built-in microphones to enable you to pay attention to your surroundings and engage in conversation without needing to remove the headset.

HearThrough settings can be configured using the Jabra Sound+ app on your smartphone or Jabra Direct on your computer.

**Left earcup**

**HearThrough**

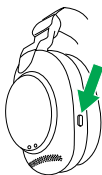

Turn on  
HearThrough

Press the **Sound modes** button to cycle through the available Sound modes until HearThrough is announced

## 7.9 Mute/unmute using the microphone boom arm

---

The headset microphone can be muted by moving the microphone boom arm up, or unmuted by moving it down.

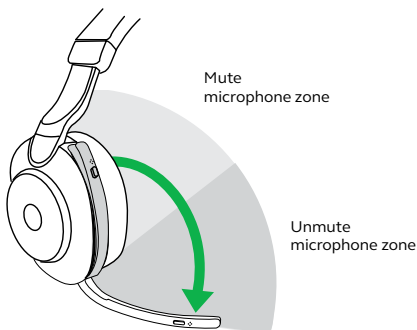

## 7.10 Answer call using the microphone boom arm

---

An incoming call can be answered by moving the microphone boom arm down.

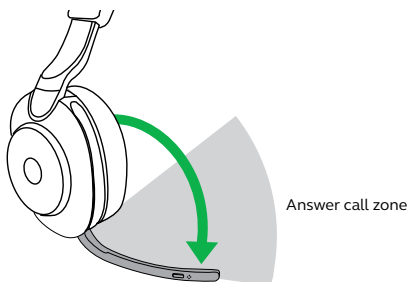

This feature is on by default, and can be disabled using Jabra Sound+ on your smartphone or Jabra Direct on your computer.

## 7.11 Multiuse

---

The headset can be paired to up to eight Bluetooth devices and connected to two Bluetooth devices at once (e.g. the Jabra Link 380 and a Smartphone, or two Bluetooth devices). The headset can accept multiple incoming calls from either device.

To pair to two Bluetooth devices, use the normal pairing process separately for each Bluetooth device (refer to section 6.2).

Note: Voice assistant will be activated on the last connected Bluetooth device.



## 7.12 Multiple call handling

---

The headset can accept and handle multiple calls at the same time.

**Right earcup**

**Multiple call handling**

End current call and answer incoming call

Press the **Answer/End call** button

Put current call on hold and answer incoming call

Hold (2 secs) the **Answer/End call** button\*

Switch between held call and active call

Hold (2 secs) the **Answer/End call** button\*

Reject incoming call, when on a call

Double-press the **Answer/End call** button

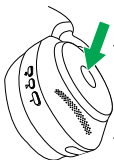

---

\*Non-Microsoft Teams headset variant only

## 7.13 Voice guidance

---

Voice guidance are announcements that will guide you through set up, or will give you headphone status updates (e.g. connection and battery status).

Voice guidance is enabled by default.

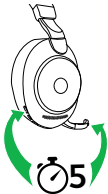
Right earcup	Voice guidance
	<p>Turn Voice guidance on/off</p> <p>Press and hold (5 sec) the <b>Voice</b> button and the <b>Volume up</b> button until you hear an announcement in the headset</p>

Alternatively, use the Jabra Sound+ app on your smartphone or Jabra Direct on your computer to turn Voice guidance on or off.

For the latest list of supported languages, refer to the Jabra Sound+ or Jabra Direct.

## 7.14 How to reset

---

Resetting the headset clears the list of paired devices and resets all settings.

Right  
earcup

Reset headset

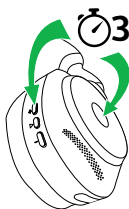

Reset pairing  
list and settings

Ensure the headset is powered on and you are not on a call. Then press and hold (3 sec) the **Multi-function** button and the **Volume up** button simultaneously until the LED lights up pink and you hear an announcement in the headset

You will need to re-pair the headset to the Jabra Link 380 using Jabra Direct, or to your Smartphone (see section 6.2)

# 8. Software and firmware

## 8.1 Jabra Sound+

---



Jabra Sound+ app



Personalize your music and calls



## 8.2 Jabra Direct

---

Jabra Direct is computer software designed to support, manage and enable optimal functionality for Jabra devices.

Download the latest free version from [jabra.com/direct](https://jabra.com/direct)

## 8.3 Update firmware

---

Firmware updates improve performance or add new functionality to Jabra devices.

The headset firmware can be updated using either Jabra Direct on your computer or the Jabra Sound+ app on your smartphone. Both applications will notify you when a firmware update is available.

The Jabra Link 380 Bluetooth adapter firmware can be updated using Jabra Direct on your computer.

# 9. Support

## 9.1 FAQ

---

View the FAQs on [Jabra.com/help/evolve2-85](https://www.jabra.com/help/evolve2-85)

## 9.2 How to care for your headset

---

- Always store the headset in the supplied case.
- To prevent the depletion of the battery lifetime or capacity, avoid storing the headset in hot or cold environments, such as a closed car in summer, or in winter conditions.
- When exposed to rain, allow the headset sufficient time to dry. It may take up to one hour for the headset to dry thoroughly and power on.
- It is recommended to keep the headset between 20°C and 55°C (-4°F and 131°F).
- Do not store the headset for extended periods of time without recharging them (max. three months).

[jabra.com/evolve2-85](http://jabra.com/evolve2-85)