

"cAP ac" user manual

Wall and Ceiling

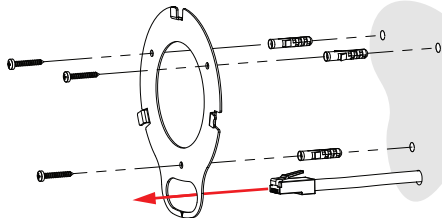

- 1) Mark and drill three holes for screw and one for ETH connector.
- 2) Plug plastic wall anchors in drilled holes.
- 3) Fix steel bracket to wall with included screws, 3pcs.

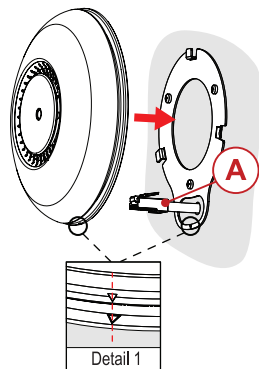

- 4) Plug ETH connector "A" to unit.
- 5) Mount product to steel bracket. For easy assembly two "marks" on parts should match in one line, see "Detail 1".

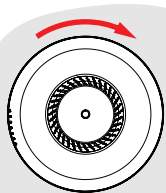

- 6) To fix enclosure rotate it clockwise.

Ceiling panel

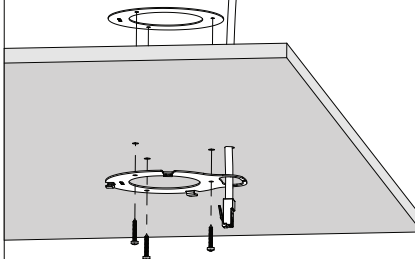

- 1) Mark and drill three holes for screw and one for ETH connector.
- 2) Both steel brackets place on opposite sides of ceiling panel.
- 3) Fix steel bracket to wall with included screws, 3pcs.

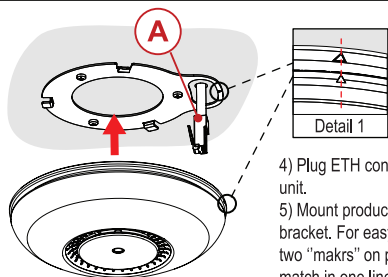

- 4) Plug ETH connector "A" to unit.
- 5) Mount product to steel bracket. For easy assembly two "marks" on parts should match in one line, see "Detail 1".

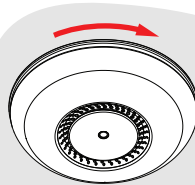

- 6) To fix enclosure rotate it clockwise.

Cover change

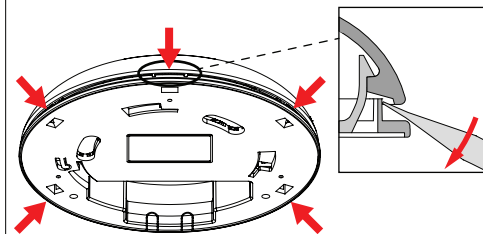

- 1) Remove COVER by opening with flat screwdriver in 5 spots.

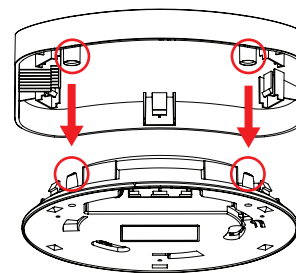

- 2) Mount COVER to BASE by matching guide cylinders.

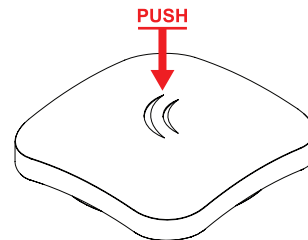

- 3) Push on COVER to fix it, should hear a "click" sound.